

FLOS

■ F9550030 Black

Wan Ceiling/Wall

Designed by Johanna Grawunder, 2005



Halogen

Wall or ceiling fixture providing direct lighting. Aluminum body, available in shiny white, shiny black and shiny green finishes. Low glare shield. Provided by two different ring due to block the safety tempered glass, in black and green.

Are you a professional and your project needs consulting and support?

[BOOK AN APPOINTMENT](#)

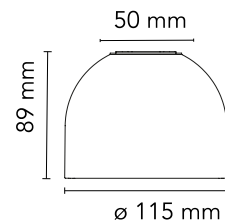

Main specifications

Mounting	Ceiling and wall surface
Environments	Indoor dry location
Light Source Type	Bulb
Lamp category	Halogen
Lamp holders	G9
Ilcos	HSG
Number of heads	1

Physical

Colour	Black
Net weight (kg)	0.62
Package height (mm)	175
Package width (mm)	220
Package length (mm)	190
Package volume (m3)	0.01

Download

[Mounting instructions](#)  PDF

[Spare Parts](#)  PDF

Photometric Files

[LDT / IES](#)  LDT

Technical Drawings

[2D](#)  ZIP

[3D](#)  ZIP



Schematic light drawing

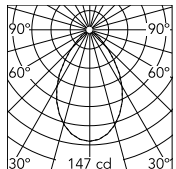

Beam Angle: 68°

h(m)	E(lx)	D(m)
1	147	1.35
2	37	2.70
3	16	4.05
4	9	5.40
5	6	6.75

Luminous flux Luminaire
460 lm

Photometric

Light distribution Symmetric

Extreme cut off No

Electrical

Insulation class II

Frequency (Hz) 50/60

Main voltage (Vac) 220-250

LED voltage Vf (Vdc) null

Dimmable Yes

Dimming interface Remote Dimmable
(Dimmer Not Included)

Batteries inside No

Bulbs



NOT INCLUDED

RF18863

Halogen Lamp G9 33W 2700K

HALOPIN Dimmable

Spare Parts

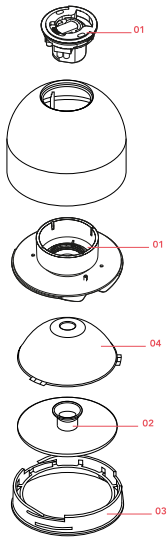

- | | | |
|-----|--|-----------|
| 01. | New type attachment assembly with g9 lamp holder and safety ring | RF9550300 |
| 02. | Wan glass assembly | RF9550200 |
| 03. | External ring | RF13990 |
| 04. | Reflector / ring assembly | RF9550130 |

DOWNLOAD



RF9550300

New type attachment assembly
with g9 lamp holder and safety
ring



RF9550200

Wan glass assembly



RF13990

External ring



RF9550130

Reflector / ring assembly